



**NEW FOR  
2007  
90° ROTATABLE  
BASE ON ALL  
MODELS**

# Self-Priming Diaphragm Pumps

- **Sand Cast Aluminum Construction for Portability and Durability**
- **Thermoplastic Rubber Diaphragm**
- **2" to 3" NPT Suction and Discharge Sizes**
- **1-5/8" Diameter Solids Handling Capability**
- **Modular Component Design Permits Easy Maintenance and Cleanout**
- **Engine Driven Models: Choice of Honda and Briggs & Stratton Gas or Yanmar Diesel Engines**
- **Delivers up to 90 GPM**
- **Maximum Temperature 180°F**

The AMT line of 2" and 3" Diaphragm pumps features 2-stage, 44 to 1 gear reduction with a large diameter output gear and heavy duty ball bearing construction. Often referred to as Mud Pumps or Sludge Pumps, diaphragm pumps are designed to pump mud, slurry, sewage, and thick liquids that have the ability to flow. AMT Diaphragm pumps are available with a choice of drivers to meet your application requirements: Briggs & Stratton or Honda gasoline engines, Yanmar Diesel, and 115 VAC electric motor with weatherproof cord and switch. Built-in molded polyurethane flap-per/check valve assures self-priming to 20 ft. after initial prime. Heavy duty gear box is designed to operate pumps at 40 strokes per minute for Electric Motor Models and 60 strokes per minute for Engine-Driven Models. Each unit includes a 2" or 3" NPT steel suction strainer, two NPT nipples, and a wheel kit with 10" semi-pneumatic transport wheels for portability. Models 336E-K6, 336G-K6, 335G-K6, and 335E-K6, are kits provided less motor or engine. Pumps are designed for use with non-flammable liquids which are compatible with pump component materials. **Suction and discharge port size cannot be reduced.**



**Model 335D-96\***

\*shown with 90° rotatable base

## INDUSTRIAL DUTY



**Model 335H-96\***

\*handle not shown



**Model 335E-96**

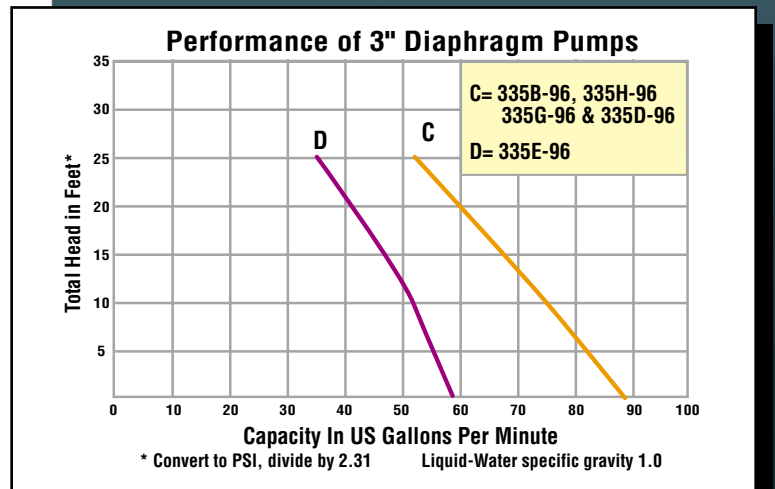
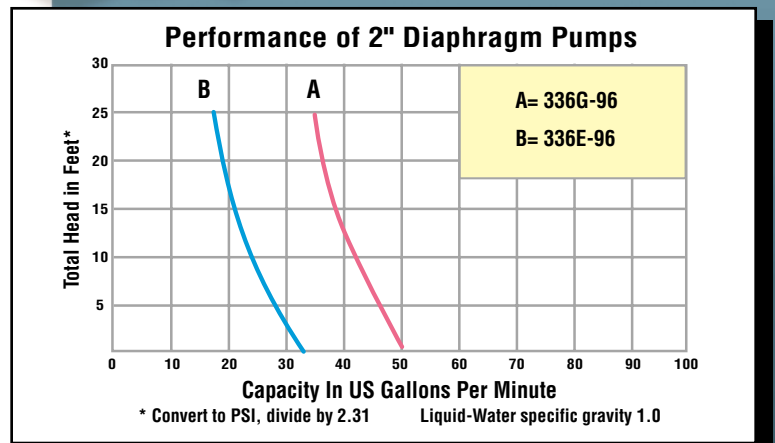

# Diaphragm Pumps

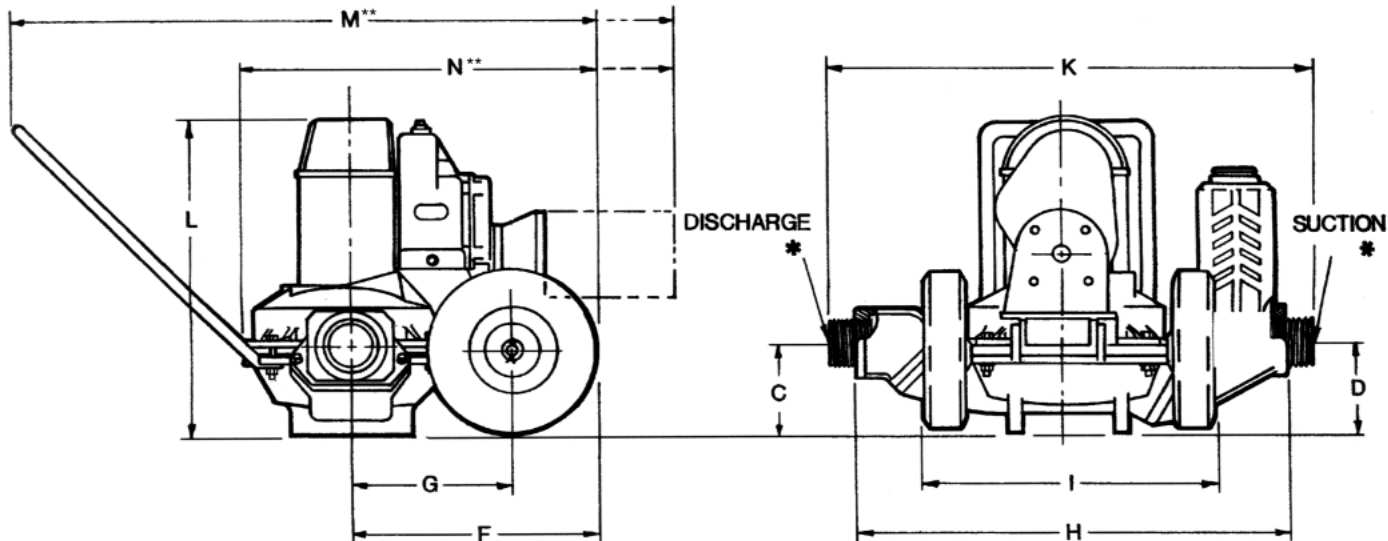

Model #	Curve	Driver	SUC*	DIS*	C	D	F	G	H	I	K	L	M**	N**	Shpg. Wt.
336G-96	A	HONDA GX120	2"	2"	7.3	5.6	17.8	12.8	22.2	18.1	25.7	23.2	39.2	25.0	125 lbs.
336E-96	B	1.5 HP Elec. Motor	2"	2"	7.3	5.6	17.8	12.8	22.2	18.1	25.7	23.2	41.1	26.8	131 lbs.
335G-96	C	HONDA GX120	3"	3"	6.2	6.3	14.5	9.5	26.5	17.9	30.0	22.0	42.0	46.0	175 lbs.
335E-96	D	1.5 HP Elec. Motor	3"	3"	6.2	6.3	14.5	9.5	26.5	17.9	30.0	22.0	43.5	27.5	186 lbs.
335B-96	C	B&S CP550	3"	3"	6.2	6.3	14.5	9.5	26.5	17.9	30.0	22.0	41.5	25.5	181 lbs.
335H-96	C	HONDA GX160	3"	3"	6.2	6.3	14.5	9.5	26.5	17.9	30.0	22.0	41.5	25.5	182 lbs.
335D-96	C	YANMAR DIESEL L48	3"	3"	6.2	6.3	14.5	9.5	26.5	17.9	30.0	22.0	43.0	27.0	203 lbs.
336G-K6	A	Kit, Less Engine	2"	2"	7.3	5.6	17.8	12.8	22.2	18.1	25.7	23.2	N/A	N/A	95 lbs.
336E-K6	B	Kit, Less Motor	2"	2"	7.3	5.6	17.8	12.8	22.2	18.1	25.7	23.2	N/A	N/A	95 lbs.
335G-K6	C	Kit, Less Engine	3"	3"	6.2	6.3	14.5	9.5	26.5	17.9	30.0	22.0	N/A	N/A	146 lbs.
335E-K6	D	Kit, Less Motor	3"	3"	6.2	6.3	14.5	9.5	26.5	17.9	30.0	22.0	N/A	N/A	146 lbs.

(\*) Standard NPT (female) pipe thread.

(\*\*) This dimension may vary due to motor or engine manufacturer's specifications.

NOTE: Dimensions have a tolerance of ±1/8".

## Standard Features for AMT Diaphragm Pumps

- ▶ Engine Driven Models - Choice of Honda, Briggs & Stratton Gas or Yanmar Diesel Engines
- ▶ 2" to 3" NPT Port Sizes
- ▶ Models 336E-96/335E-96 – 1.5 HP single phase, 115/230 Volt motor with manual reset overload includes 20 foot 115 VAC power cord and weather-proof on/off switch
- ▶ Models 336G-K6/335G-K6 – Kit, furnished less engine. For use with gasoline or diesel engines with .75" keyed shaft (SAE J609a Mounting Flange)
- ▶ Model 336E-K6/335E-K6 – Kit, furnished less motor. For use with electric motor (1725 RPM) or air motor with a minimum of 1.5 HP. 56C Mounting Flange required.



90° rotatable base on all models



WARNING: Do not use in explosive atmosphere or for pumping volatile flammable liquids.

See price book page 13

The Gorman-Rupp Company reserves the right to discontinue any model or change specifications at any time without incurring any obligation.

CP35-36/0906